

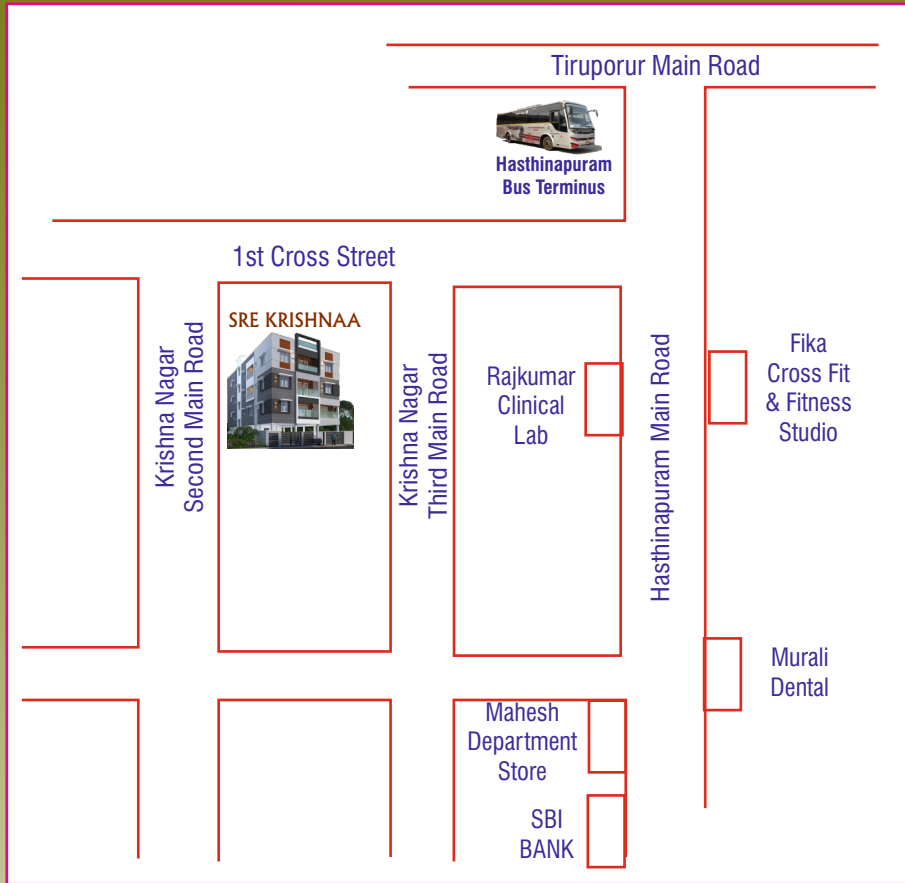

**Sankar Constructions**



**Sankar Constructions**

Plot No.32, First Floor, Hariharan Towers, R.P. Road  
Chromepet, Chennai - 600044.

**Mob. : 98416 59929 / 98416 59930**

Email : [sankarconstructions2006@gmail.com](mailto:sankarconstructions2006@gmail.com)

Web : [www.sankarconstructions.in](http://www.sankarconstructions.in)



**SRE KRISHNAA**



Plot No.8, Krishna Nagar  
Second Main Road,  
Chromepet, Chennai - 600044.

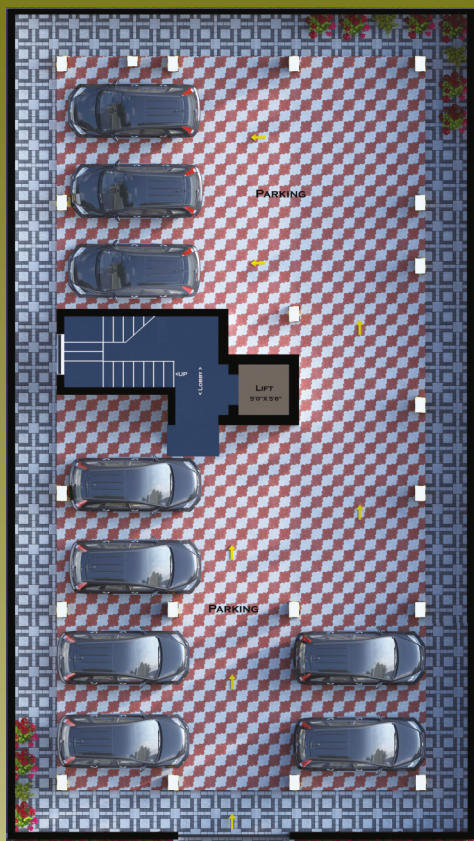

GROUND FLOOR PLAN



FIRST FLOOR PLAN



SECOND & THIRD FLOOR PLAN

S.No.	FLAT	AREA	UDS
1.	F2	1287 Sq.ft.	520 Sq.ft.
2.	S1	1730 Sq.ft.	700 Sq.ft.
3.	S2	1369 Sq.ft.	554 Sq.ft.
4.	T1	1730 Sq.ft.	700 Sq.ft.
5.	T2	1369 Sq.ft.	554 Sq.ft.

**PAYMENT**

AT THE TIME OF BOOKING	Rs.1,00,000
AT THE TIME OF AGREEMENT (WITHIN 10 DAYS FROM THE DATE OF BOOKING)	20%
AT THE TIME OF REGISTRATION (WITHIN 20 DAYS FROM THE DATE OF BOOKING)	35%
ON COMPLETION OF FOUNDATION WORK	10%
ON COMPLETION OF 1st FLOOR ROOF SLAB	10%
ON COMPLETION OF BRICK WORK	10%
ON COMPLETION OF PLASTERING WORK	05%
ON COMPLETION OF FLOORING WORK	05%
AT THE TIME OF HANDING OVER	BALANCE

**AMENITIES :**

- WITH LIFT UPTO TERRACE
- INDIVIDUAL COVERED CARPARKING
- 24 HOURS POWER BACKUP
- AS PER VAASTHU
- CCTV CAMERA
- AUTOMATIC WATER TANK CONTROL LEVELLER
- VIDEO DOOR PHONE

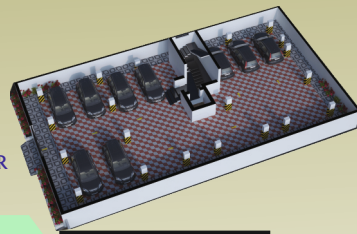

GROUND FLOOR PLAN



FIRST FLOOR PLAN



SECOND & THIRD FLOOR PLAN

**SPECIFICATIONS**

**STRUCTURE :** RCC framed Structure

**JOINERY :** Main Door - Teak Wood frame and Panelled Shutter  
Other Door - Modular flush door with teak wood frames  
Windows UPVC Frames Open (or) glazed shutter and M.S. Grills

**FLOORING :** 2x2 Johnson Vitrified tiles over a layer of cement mortar

**KITCHEN :** Glazed tiles, cladding 2'6" height over granite cooky platform and stainless steel sink.

**BATHROOM :** (Jaquar tap fittings) Ceramic flooring and concept glazed tiles cladding upto 7'0" height. One EWC (Whitecolour, Parry ware Cascade equivalent brand) IWC for other toilet in each flat. Hot and Cold Water plumbing arrangements using Jaquar tap Fittings. Concealed line in CPVC and PVC for open line. One colour wash basin 20"x16" in common area and other in attached bathroom.



**PREFERRED BANKS**



**Sankar Constructions**

Plot No.32, First Floor, Hariharan Towers, R.P. Road Chromepet, Chennai - 600044.

**Mob. : 98416 59929 / 98416 59930**

Email : [sankarconstructions2006@gmail.com](mailto:sankarconstructions2006@gmail.com)  
Web : [www.sankarconstructions.in](http://www.sankarconstructions.in)

**ELECTRICAL :** Concealed 3 phase copper wiring. (ISI approved) brand ) A/C point in Master Bed Room and Geyser point in attached toilet. Provision for exhaust fan in Kitchen. Anchor Switches.

**TELEPHONE / T.V. POINTS :** In living Room.

**PLUMBING WORKS :** Open and concealed soil lines in PVC adequate number of Sewage inspection Chambers.

**WATER SUPPLY :** A Borewell to tap ground water. Arrangement for pumping water to overhead tank will be provided.

**PAINTING :** Emulsion paint for internal over a coat of putty exterior emulsion for external walls coat advance Damp Proof and synthetic enamel paint for doors and windows.

**CUPBOARD AND LOFTS :** One Loft and one cupboard with cuddappah shelves in each bedroom and kitchen.

**LIFTS :** Lift will be provided connecting ground floor to terrace